

## WELS products



The WELS website has a product database. Go to <http://search.waterrating.com.au> to search for WELS-rated products.

For more information go to the **WELS** website at: [www.waterrating.gov.au](http://www.waterrating.gov.au)

You can order WELS information materials by emailing [ciu@deh.gov.au](mailto:ciu@deh.gov.au) or calling **1800 803 772**

## WELS water-saving facts

- By 2021 Australians using more water-efficient products can:
  - save more than \$600 million on water and energy bills
  - save more than 87,200 megalitres of water per year (about 43,000 Olympic swimming pools).
- A water-efficient washing machine can use up to 2/3 less water than an inefficient model.
- More efficient toilets use up to 9 litres less water per flush than older models.
- An efficient showerhead can save up to 18 litres of water per minute compared with a traditional model.

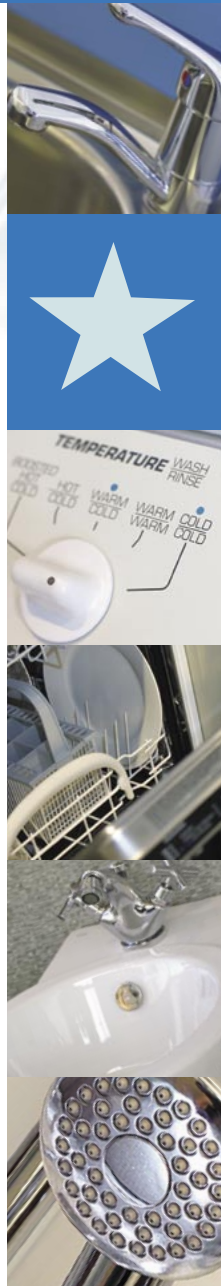

Australian Government

# WELS – Australia's new Water Efficiency Labelling Scheme

*Don't buy a water-using product without finding out how **WELS** water-efficiency ratings can save you money and help save water*

The more stars the more water efficient

## WATER RATING

A joint government and industry program  
Licence No. nnnn

Water Consumption

**9**  
litres per minute

When tested in accordance with Standard AS/NZS 6400

For more information and to compare products, refer to:  
[www.waterrating.gov.au](http://www.waterrating.gov.au)

ROAR 3901

## What is **WELS**?

- You can now buy products that are labelled for water efficiency.
- **WELS** means that product sellers, such as retailers, plumbers, wholesalers and developers, are now legally required to label products for water efficiency.
- By buying more water-efficient products you can save money on water and electricity bills and help save the environment.



## What does the **WELS** label look like?

The labels for the different **WELS** products also differ slightly, however all share two key pieces of information:

- the star rating
- the water consumption or flow figures.

The stars show water efficiency  
– aim for 4 or 5 stars

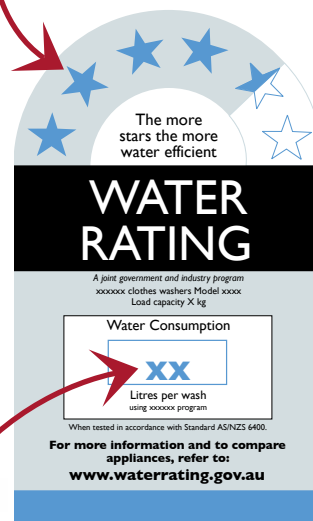

Look for the:

- average water consumption per use figure (dishwashers, washing machines, toilets, urinals)
- average water flow per minute figure (taps, showers)

## What is the testing process behind the label?

The star rating and water consumption/flow figures on the product label are based on rigorous and independent water efficiency tests.

## What does the 'zero star rated' label mean?

A product is given a zero rated label if it fails **WELS** tests – zero star products may need to be used in some cases such as areas with low-pressure or gravity-fed systems. Please consult your plumber.



## What are the **WELS** products?

The **WELS** products are dishwashers, washing machines, taps, showers, toilets, urinals and flow controllers.

## Rebates

Ask your local water authority or government if they offer rebates for people buying water-efficient appliances.